

Yankeetown

6241 Harmony Lane
Yankeetown, Fl. 34498
(352) 447-2511 Phone
(352) 447-0774 Fax
(352) 628-7904 Inspection Line
www.yankeetownth@gmail.com

SITE PLAN FORM

Date: _____ Parcel I.D.#: _____
Lot #: _____ Block #: _____ Subdivision: _____
Property Address: _____

SETBACKS REQUIRED

RESIDENTIAL RHD-1, RHD-2 & RLD:

Front: 25 ft.
Sides: 8 ft.
Rear: 10 ft.

AGRICULTURE A-1:

Front: none
Sides: none
Rear: none

COMMERCIAL C-1 & C-2:

Front: none
Sides: none
Rear: none

PUBLIC:

Front: none
Sides: none
Rear: none

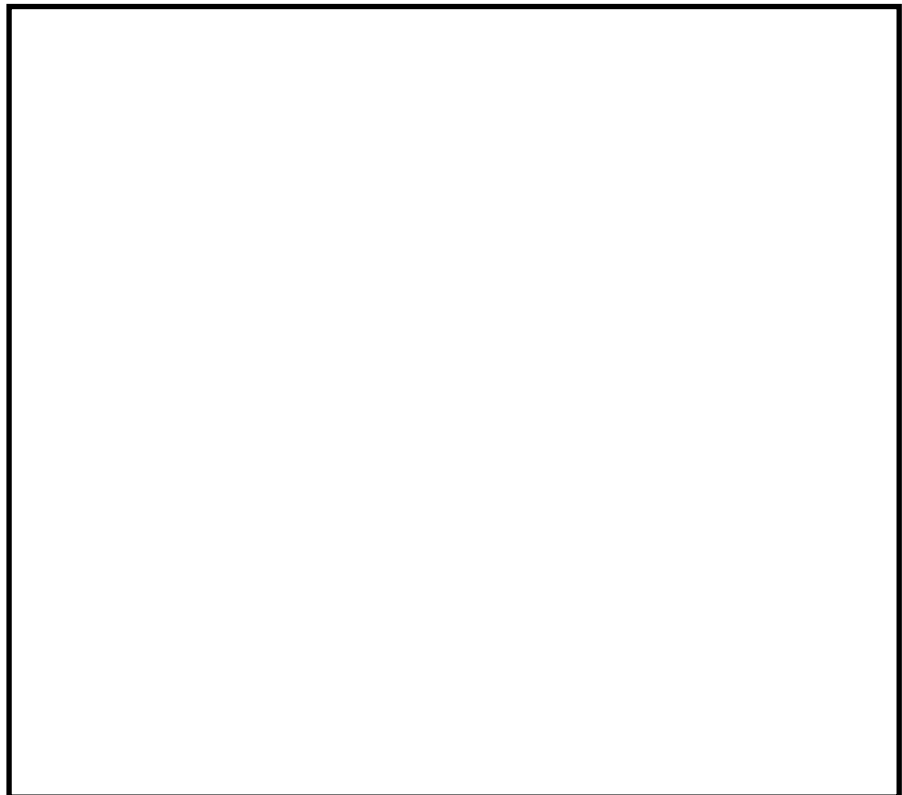

STREET

- 1. Show all existing and proposed buildings.
- 2. Show dimensions of buildings and the distances of all buildings to all property lines.
- 3. Show all streets abutting property.
- 4. Indicate with a dashed line, any water or depressions.

FLOOD ZONE (MAP PANEL NO. 1295820001B - Effective date 2/1/1987)

Choose one: This building site is located within a flood prone area.
 This building site is **not** located within a flood prone area.

Zoning Office: _____ Date: _____

I acknowledge that there may be additional restrictions applicable to this property that may be found in the public records of the county, and there may be additional permits required from other entities such as water management, state or county agencies and federal agencies.

Owner/Agent

Date

Yankeetown

SITE PLAN

LEGAL DESCRIPTION

1. Show shape and dimensions of property.
2. Show all existing and proposed buildings.
3. Show dimensions of buildings and the distance of all buildings to all property lines.
4. Show all streets abutting property.
5. Indicate, with a dashed line, any water or depressions.

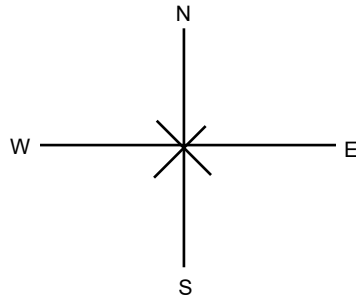

Example:

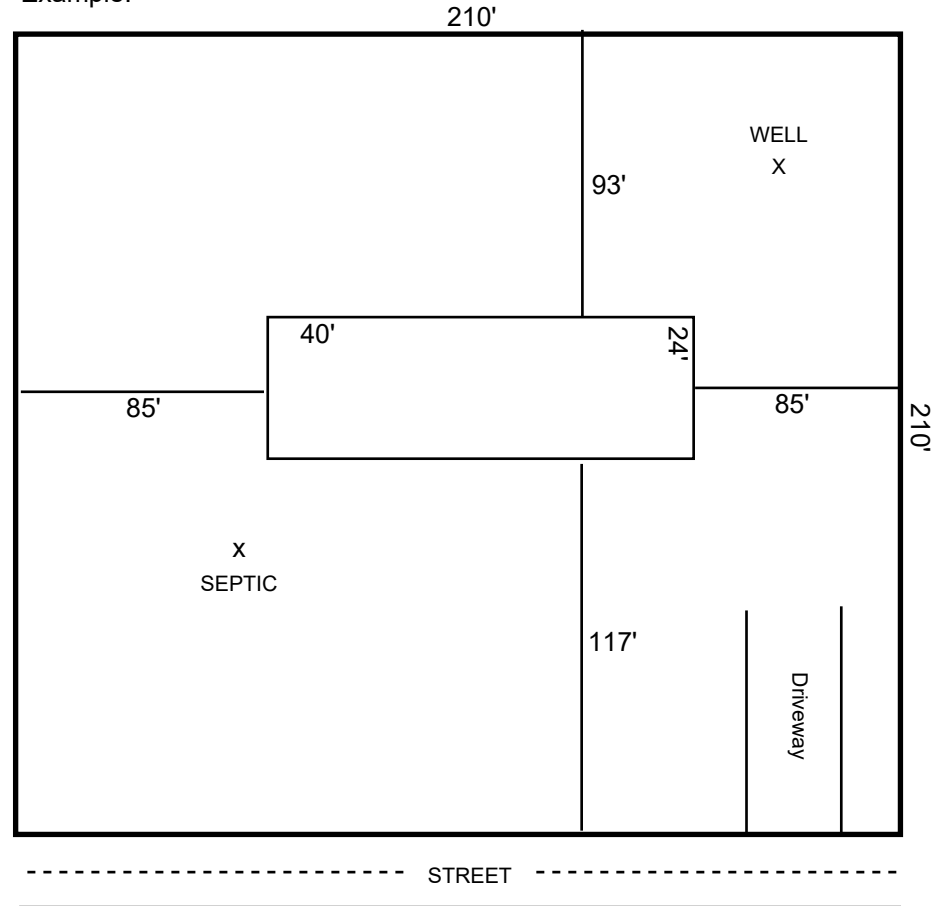

LEGAL DESCRIPTION

Parcel #: _____

Subdivision: _____ Lot: _____ Block: _____

Section: _____ Township: _____ Range: _____

Metes and Bounds: _____

Yankeetown

6241 Harmony Lane
Yankeetown, Fl. 34498
(352) 447-2511 Phone
(352) 447-0774 Fax
(352) 628-7904 Inspection Line
www.yankeetownth@gmail.com

**ZONING, LAND DEVELOPMENT REGULATIONS,
LOT/YARD/HEIGHT REGULATIONS**

NOTICE TO PROPERTY OWNERS AND CONTRACTORS

"It is the responsibility of the landowner to establish the true boundaries of property, to enable the Town of Yankeetown to confirm compliance with the setback requirements. On smaller parcels, this may be accomplished by the use of string or wire between corners, or by the staking out of the building foundation by licensed surveyors. Regardless of the size of the parcel, when there remains question, require a Licensed Professional Surveyor to locate the foundation on a survey map and provide it to the office of the Building Official. The survey is to be at the land owners expense."

Property Owner Signature: _____

Property Owner Print Name: _____

Date: _____

Contractor Signature: _____

Contractor Print Name: _____

Date: _____